

# Tacoma Bollard

## Overview

The Tacoma bollard features aluminum extruded square tube with 4 vertical aluminum square bar accents laser cut and milled for maximum strength. Bollard head is constructed from a combination of cast and fabricated aluminum. Designed to illuminate pathways, it also enhances safety by clearly defining property boundaries for drivers.

## Size

Available in standard 6" and 8" square size with standard heights (30", 36", 42" and 48"). Custom size and heights available.

## Electrical

- Watts: 10, 12, 15, 20 and 30W
- Voltage: 120v through 277v (U). 347-480v (HV).

## LED

High performance LED CRI: 80. Color temperature ranges from CCT: 2700K - 5000K. Also available in Amber LED array, 560nm + (AMBR).

## Optics

Available Optics: Type II (T2), Type III (T3), Type IV (T4), and Type V (T5).

## Mounting

Heavy duty steel base (IBP) installs on the ground with heavy duty anchor bolts (four anchor bolts, nuts and washers). External base plate (ESM) also available, consult factory.

## Finish

Outdoor polyester powder coat, available in our Zuma standard finishes with a four-step pretreat process to ensure optimal adhesion and surface integrity. Also available in custom RAL and in marine grade finish (MGF), specify.

## Controls

- Dimming. 0-10v dimming (D) available.
- Photocell: Small button Style photo cell available in 120V (PH1)<sup>1</sup> or 120v through 277v (PH2) on side of fixture<sup>2</sup>.
- Motion Sensor (M)

<sup>1</sup> For use with 120v input voltage only.  
<sup>2</sup> For use with 120v through 277v universal voltage (U) only.

## Options

- Bollard can be made to "Buy American Compliant" (BAA)<sup>1</sup> and "Build America, Buy America Act Compliant" (BABA)<sup>1</sup> (includes BAA)
- Emergency Battery Backup (EMB)
- Sky Night Friendly (SKY)
- 180° Houseside Shield on Optics (HSSOP)
- Perforated Screen 180° (PS180)
- Perforated Screen 360° (PS360)
- Surge Protection (S): Field installed in the bottom of the bollard.
- Marine grade finish (MGF) available in standard and custom colors, consult factory.
- Vandal Resistance Hardware (VRH): Optional vandal resistant stainless steel hardware installed for added security.

<sup>1</sup> Must specify at time of ordering in order to ensure product is manufactured to meet all required compliances.



## Certificates & Warranty

- Designed to comply with UL 8750
- Suitable for Wet Locations
- 5-Year Warranty

## Technical

- Operating Temperature: -40°F to 95°F (-40°C to 35°C)

DISCLAIMER - The information provided in this document is subject to change without notice. Zuma Lighting reserves the right to modify product specifications and design at any time. Please consult with our representatives for the most current and accurate information.



# Tacoma Bollard

Item	Size	Wattage	Volts	Color Temp	Optics	Mounting	Finish	Controls	Options
<b>TAC-B</b> Tacoma Bollard	<b>0630</b> 6" Squ. x 30"H	<b>10W</b>	<b>U</b> 120v-277v	<b>27K</b> 2700K	<b>T2</b> Type II	<b>IBP</b> Internal Baseplate (Std.)	<b>BZ8</b> Zuma Bronze	<b>D</b> Dimming (0-10v)	<b>BAA</b> <sup>1</sup> Buy American Act Compliant
	<b>0636</b> 6" Squ. x 36"H	<b>12W</b>	<b>HV</b> 347v - 480v	<b>3K</b> 3000K	<b>T3</b> Type III	<b>ESM</b> External Surface Mount	<b>BK</b> GT Black	<b>PC</b> Photocell	<b>BABA</b> <sup>1</sup> Build America, Buy America Act Compliant
	<b>0642</b> 6" Squ. x 42"H	<b>15W</b>		<b>35K</b> 3500K	<b>T4</b> Type IV		<b>SL</b> Iridium Silver	<b>M</b> Motion Sensor	<b>EMB</b> Emergency Battery Backup
	<b>0648</b> 6" Squ. x 48"H	<b>20W</b>		<b>4K</b> 4000K	<b>T5</b> Type V		<b>WH</b> Alpine White		<b>SKY</b> Sky Night Friendly
	<b>0830</b> 8" Squ. x 30"H	<b>30W</b>		<b>45K</b> 4500K			<b>GRY</b> Granite Gray		<b>HSSOP</b> 180° Houseside Shield (Optics)
	<b>0836</b> 8" Squ. x 36"H			<b>5K</b> 5000K			<b>GRN</b> Moss Green		<b>S</b> Surge Protection
	<b>0842</b> 8" Squ. x 42"H			<b>AMBR</b> <sup>2</sup> 560nm+			<b>CCxxx</b> <sup>3</sup> Custom Color		<b>MGF</b> Marine Grade Finish
	<b>0848</b> 8" Squ. x 48"H								<b>VRH</b> Vandal Resistant Hardware
	<b>CH</b> <sup>4</sup> Custom Size								

1 Consult our sales team for detailed information on compliance with domestic manufacturing regulations.  
2 Amber lighting is for turtle and wildlife friendly requirements (560nm+) and lumen outputs will be reduced to approximately 40-50 lm/w.  
3 Custom colors: Available in smooth and textured finishes. Also available in RAL and Sherwin Williams colors, consult factory.  
4 For custom head sizes specify width and depth in inches (e.g.: CS65 = 6" Wide x 5" Deep). Min Width: 6.00". Min Depth: 3.00".



# Tacoma Bollard

## Dimensions

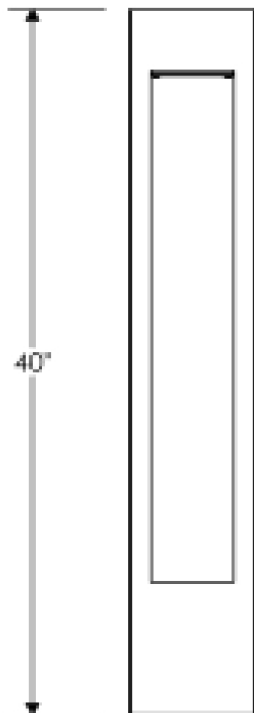
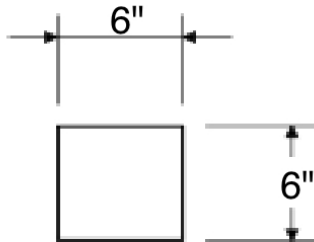

### Mounting Template

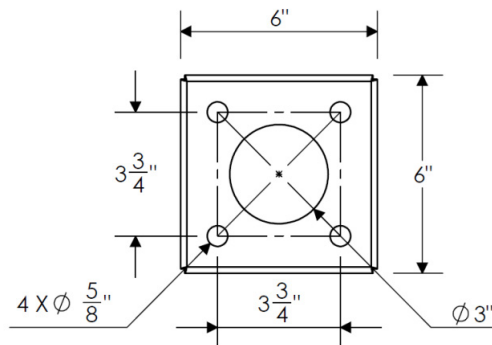

Shown with 6" Sq x 40": H  
Other Standard and Cusotm Sizes Available.