

# Mariposa Bollard

## Overview

The Mariposa bollard shaft is constructed from extruded aluminum tubing. Bollard head is constructed from a combination of cast and fabricated aluminum. Designed to illuminate pathways, it also enhances safety by clearly defining property boundaries for drivers.

## Electrical

- Watts: 10, 12, 15, 20 and 30W
- Voltage: 120v through 277v (U). 347-480v (HV).

## LED

High performance LED CRI: 80. Color temperature ranges from CCT: 2700K - 5000K. Also available in Amber LED array.

## Optics

Available Optics: Type II (T2), Type III (T3), Type IV (T4), and Type V (T5).

## Mounting

Heavy duty internal baseplate (IBP) installs on the ground with anchor bolts (four anchor bolts, nuts and washers). External base plate (ESM) also available, consult factory.

## Finish

Outdoor polyester powder coat, available in our Zuma standard finishes with a four-step pretreat process to ensure optimal adhesion and surface integrity. Also available in custom RAL and in marine grade finish (MGF), specify.

## Controls

- Dimming. 0-10v dimming (D) available.
- Photocell: Small button Style photo cell available in 120V (PH1)<sup>1</sup> or 120v through 277v (PH2) on side of fixture<sup>2</sup>.
- Motion Sensor (M)

<sup>1</sup> For use with 120v input voltage only.

<sup>2</sup> For use with 120v through 277v universal voltage (U) only.

## Options

- Bollard can be made to "Buy American Compliant" (BAA)<sup>1</sup> and "Build America, Buy America Act Compliant" (BABA)<sup>1</sup> (includes BAA)
- Emergency Battery Backup (EMB)
- Sky Night Friendly (SKY)
- 180° Houseside Shield on Optics (HSSOP)
- Surge Protection (S): Field installed in the bottom of the bollard.
- Marine grade finish (MGF) available in standard and custom colors, consult factory.
- Vandal Resistance Hardware (VRH): Optional vandal resistant stainless steel hardware installed for added security.

<sup>1</sup> Must specify at time of ordering in order to ensure product is manufactured to meet all required compliances.



## Certificates & Warranty

- Designed to comply with UL 8750
- Suitable for Wet Locations
- 5-Year Warranty

## Technical

- Operating Temperature: -40°F to 95°F (-40°C to 35°C)





ZUMALIGHTING

Project \_\_\_\_\_ Type \_\_\_\_\_ Qty \_\_\_\_\_

Company \_\_\_\_\_ Part # \_\_\_\_\_

# Mariposa Bollard

Example Code: MAR-B-12W-HV-3K-T3-IBP-WH-D-PC-M-BAA-EMB-SKY-HSS-S

Item	Wattage	Volts	Color Temp	Optics	Mounting	Finish	Controls	Options
MAR-B Mariposa Bollard	10W	U 120v - 277v	27K 2,700K	T2 Type II	IBP Internal Baseplate (Std.)	BZ8 Zuma Bronze	D Dimming (0-10v)	BAA <sup>1</sup> Buy American Act Compliant
	12W	HV 347v - 480v	3K 3,000K	T3 Type III	ESM External Surface Mount	BK GT Black	PC Photocell	BABA <sup>1</sup> Build America, Buy America Act Compliant
	15W		35K 3,500K	T4 Type IV		SL Iridium Silver	M Motion Sensor	EMB Emergency Battery Backup
	20W		4K 4,000K	T5 Type V		WH Alpine White		SKY Sky Night Friendly
	30W		45K 4,500K			GRY Granite Gray		HSSOP 180° Houseside Shield (Optics)
			5K 5,000K			GRN Moss Green		S Surge Protection
			AMBR <sup>2</sup> 560nm+			CCxxx <sup>3</sup> Custom Color		MGF Marine Grade Finish
								VRH Vandal Resistant Hardware

1 Consult our sales team for detailed information on compliance with domestic manufacturing regulations.  
2 Amber lighting is for turtle and wildlife friendly requirements (560nm+) and lumen outputs will be reduced to approximately 40-50 lm/w.  
3 Custom colors: Available in smooth and textured finishes. Also available in RAL and Sherwin Williams colors, consult factory.



# Mariposa Bollard

## Dimensions

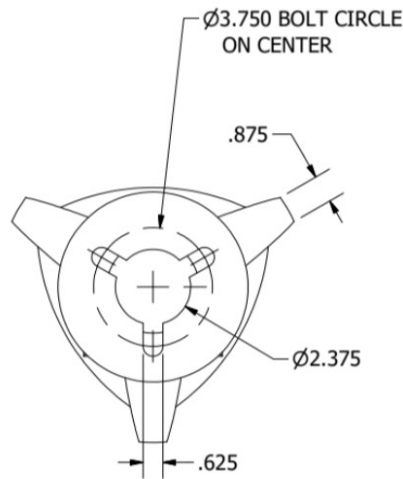
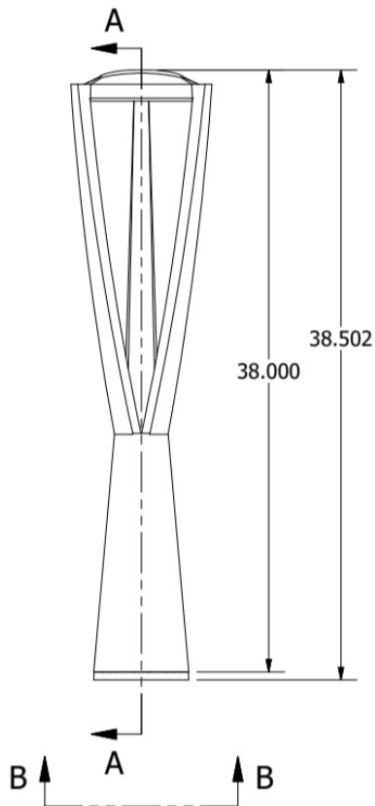
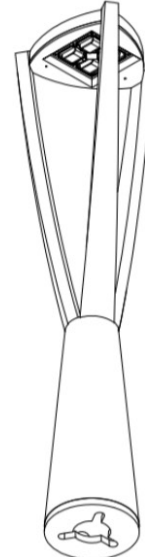
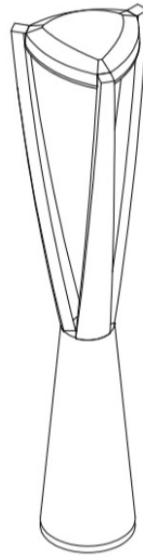
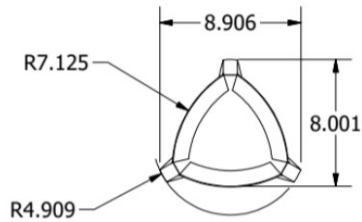

VIEW B-B

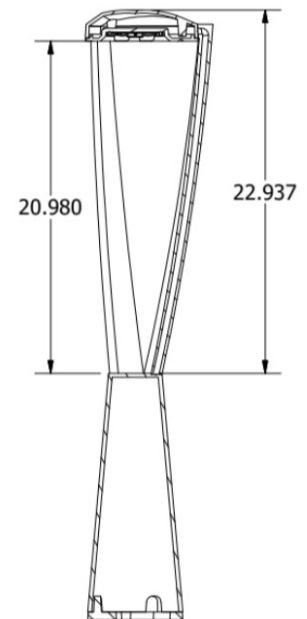

SECTION A-A